

BASE CABINET SPECIFICATIONS - STANDARD & DOMESTIC

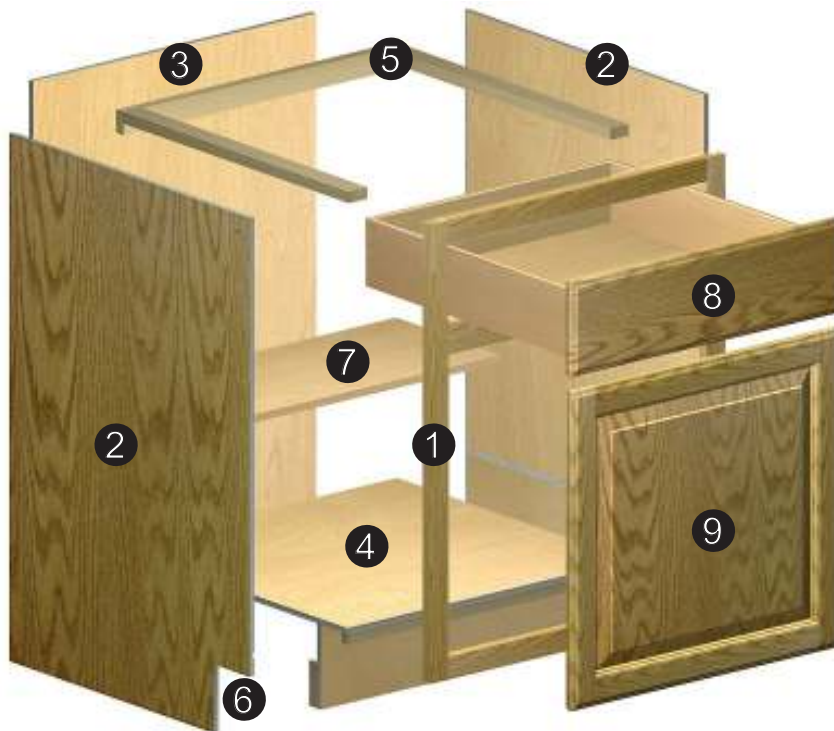

CABINET CONSTRUCTION STANDARD and DOMESTIC Option

- 1** Cabinet fronts
 - 3/4" solid wood
 - Front stiles are pocket drilled and assembled with 1 1/4" screws for rugged durability
- 2** Side panels
 - 3/8" particle board
 - DOMESTIC Option: 3/8" plywood**
 - Vinyl covered on both sides
 - Glued and stapled in a 3/8" dado in the cabinet's front frame
- 3** Back panels
 - 3/8" particle board
 - DOMESTIC Option: 3/8" plywood**
 - Vinyl covered on inside only
 - Glued and nailed in a 3/8" dado and stapled to the hang rail and cabinet bottom
- 4** Floor Panels
 - 3/8" particle board
 - DOMESTIC Option: 3/8" plywood**
 - Vinyl covered on inside only
- 5** Hanging rails
 - 3/4" x 1 1/2" all wood
 - Installed on sides and back.
- 6** Toe kick: 4 1/2" high x 4" deep
- 7** Shelves
 - Fixed 1/2" MDF
 - DOMESTIC Option: Fixed 1/2" plywood**
 - Bullnose, foil-covered front edges
- 8** Drawers
 - 1/2" MDF
 - NOTE: Cabinets 27" - 36" wide use 1/2" finished solid wood**
 - DOMESTIC Option: 1/2" finished solid wood**
 - Bullnose, foil-covered top edges
 - Dovetail construction
 - Drawers glide smoothly on self-adjusting ball bearing nylon guides
- 9** Doors
 - **Butt Doors: Standard on 27" - 36" wide cabinets; Available on 24"**
 - Door Construction Specifications are on pages 39 and 40

Finish

All cabinet front and door surfaces receive stain and a catalyzed clear or a catalyzed paint finish. Our finish provides a deep, rich wood tone that is resistant to household chemicals, water, food stains and mild acids.

Hinges

Hidden, self-closing adjustable hinge

Optional Construction Features

- See page 6 for option details
- **Handicap and Handicap Accessible**
- Please refer to separate Price & Spec book.