

**Wainscot Panels Order Form
Miter Door Styles**

Fax completed form with order

Account Number: _____

Date: _____

Company: _____

Door Style _____

Contact: _____

Species _____

Phone Number: _____

Finish _____

PO/Order Number: _____

Job Reference: _____

Use this form for Miter door styles: Burnham, Dawson, MacKenzie, Portico, Sullivan
Jamison, Toulon, Villa and new miter door introductions.

Directions

- In the box below, please record the exact measurements (in inches) of the panel to be ordered.
- Recording the width measurement to the nearest one-sixteenth (1/8) of an inch
- **Rabbet end** is standard and the only end available on Miter door style panels for application over OC moulding. **Square end option is not available.**
- **Toe kick options** are not available on miter wainscot panels, recommend using moulding application WCM over FWCM or another 4.5" tall moulding.
- Due to customized sizes, wainscot panels cannot be returned

Wainscot Panel Dimensions	
_____ W	_____ H
_____ x _____	

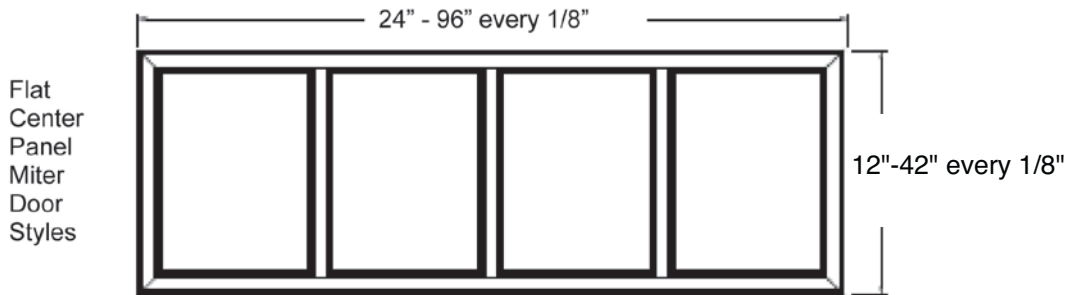

Flat
Center
Panel
Miter
Door
Styles

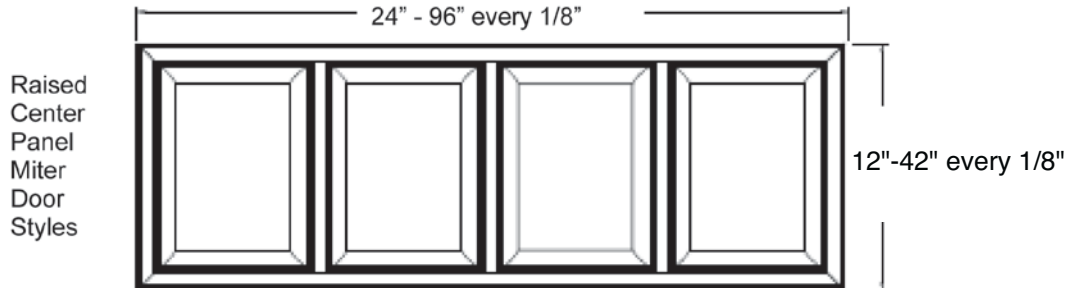

Raised
Center
Panel
Miter
Door
Styles

64" - 83" panel shown

**Wainscot Panels Order Form
Mortise and Tenon Door Styles**

Fax completed form with order

Account Number: _____

Date: _____

Company: _____

Door Style _____

Contact: _____

Species _____

Phone Number: _____

Finish _____



PO/Order Number: _____

Job Reference: _____

Use this form for Mortise and Tenon door styles: Adams, Arlington, Broadmoor, Concord, Copenhagen, Cottage, Duncan, Thomas, Eastlake, Hancock, Hartford, Jacobsen, Lewis, Allen, Parsons, Terence, Mission, Gilbert, Gerrit, Roycroft and new door style introductions. **Not available in:** Arch, Princeton, Towne, Rohe, or Foil

Directions

- In the box below, please record the exact measurements (in inches) of the panel to be ordered.
- Record the width and height measurement to the nearest one-sixteenth (1/8) of an inch
- Due to customized sizes, wainscot panels cannot be returned
- Not recommended for use with Flush End option on cabinets

WAINSCOT PANEL SIZE	
_____ W	_____ H
_____ x _____	
Height without toe kick	
Toe Kick and Stile Options	
_____ FTK adds 4.5" to height	
_____ TKL cutout left	
_____ TKR cutout right	
_____ TKB cutout both	
_____ 6" Stile, Indicate Location	
_____ Right side	
_____ Left side	
_____ Both	
End Options	
Standard Rabbet end with profile	
Left _____ Right _____ Both _____	
Profiled end No Rabbet	
Left _____ Right _____ Both _____	
Squared end No Profile	
Left _____ Right _____ Both _____	
Finished Size	
_____ W	_____ H
_____ x _____	

